

**PROPOSED ORDER DETAIL**

Scale: Not to Scale

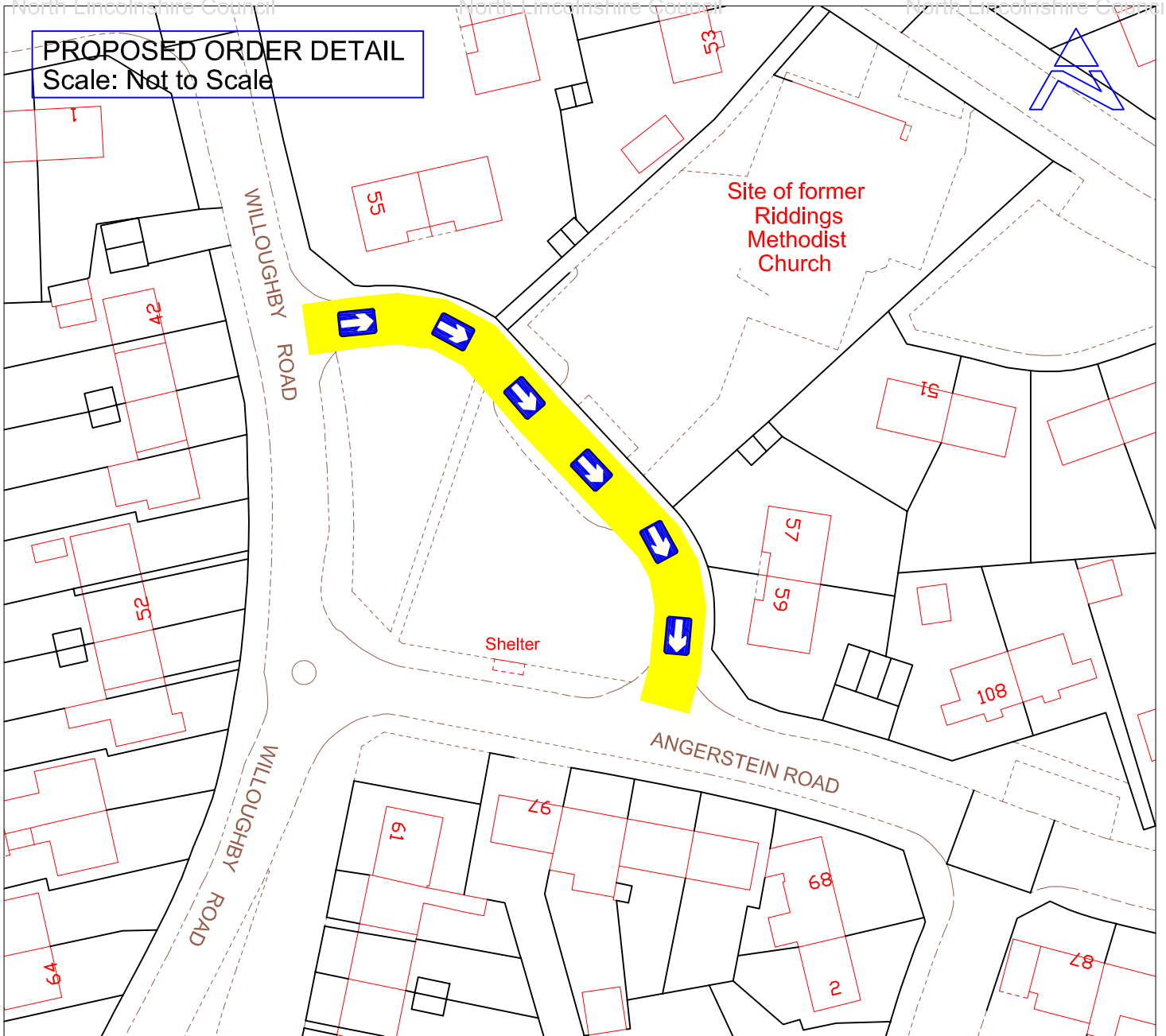

**KEY**

**Proposed Restrictions**



Extent of Proposed One-Way Traffic order  
Direction of arrow shows direction of travel

REV	DETAILS	APPROVED BY	DATE APPROVED
-----	---------	-------------	---------------

**North Lincolnshire Council**

Director  
Economy and Environment  
Helen Manderson

Based upon the Ordnance Survey mapping with the permission of Ordnance Survey on behalf of the Controller of Her Majesty's Stationary Office. © Crown Copyright.  
Unauthorised reproduction infringes Crown Copyright and may lead to prosecution or civil proceedings.

NORTH LINCOLNSHIRE COUNCIL 2018 0100023560

DRAWING TITLE

**Proposed One-way movement order - Willoughby Road, Scunthorpe**

DRAWN BY ICJ	SCALE Not to Scale	CHECKED BY <i>J. Willcock</i>	DATE CHECKED 10/11/2022	APPROVED BY <i>[Signature]</i>	DATE APPROVED 11/11/2022
-----------------	-----------------------	----------------------------------	----------------------------	-----------------------------------	-----------------------------

PROJECT TITLE Traffic Regulation Order	DRAWING NUMBER YHN5006/22/004/001	REV
---	--------------------------------------	-----