

Determined **School Admission arrangements for St Peter** **and St Paul Church of England Primary School** **for the academic year 2022/23**

The school was founded to provide education for children of the parish of Bottesford with Ashby.

It is a school for the whole community whilst it seeks to offer Christian based education to all children; grounded in the Diocesan vision of “excellence, exploration and encouragement within the love of God”. The school values the involvement of all parents in supporting the school’s Christian ethos. As a Church of England school, we hold regular Christian collective worship and festivals, both in school and in Church.

Published Admission Number

The admission number for the intake year group for the academic year 2022/23 will be set at 45.

Admission Arrangements

Applying for a School Place

Details of how and when to apply, and how places will be offered, are in the “Determined Co-ordinated Admissions Scheme for Primary, Infant and Junior Schools in the area of North Lincolnshire Council for the academic year 2022/23”. When they are published they will be available on the North Lincolnshire Council website www.northlincs.gov.uk

Children with Education Health and Care Plans

In accordance with the Code of Practice for Special Educational Needs, the allocation of school places for these pupils will take place before the allocation of other places as part of the annual admissions process. Where a school is named in a child’s plan the school has a duty to admit the pupil. This will reduce the number of places available.

Oversubscription criteria

Where the school has more applications than places the following factors will be taken into account in priority order when deciding which pupils will be allocated places. The governing body have adopted the same admissions criteria as North Lincolnshire Council for community and voluntary controlled schools.

1 – Looked after Child or Child in Care

A 'looked after child' or a child who was previously looked after but immediately after being looked after became subject to an adoption, child arrangements, or special guardianship order.

A looked after child is a child who is;

- (a) in the care of the local authority, or
- (b) being provided with accommodation by the local authority in the exercise of their social services functions (see the definition in section 22(1) of the Children Act 1989) at the time of making an application to the school.

A previously looked after child is a child who;

- (a) ceased to be looked after because they were adopted or
 - (b) became subject to a child arrangements order, or
 - (c) became subject to a special guardianship order,
- immediately after being looked after, including those who appear to have been in state care outside of England and ceased to be in state care as a result of being adopted.

2 - Children who live in the school's designated catchment area.

Parents can see which catchment areas cover their address by following the link from the "Apply for a school place" page at www.northlincs.gov.uk.

A map of the catchment area for St Peter and St Paul Church of England Primary School is included in this document.

The address taken under this factor will be that on Friday 11 February 2022.

Parents who move after submitting their preference must inform the council's Admissions Team of any change of address.

For admission purposes, the home address is where a child usually lives with their parent or carer. **You must not give the address of a childminder or relative.** Where a child lives with parents with shared responsibility, each for part of the week, and the school has been given more than one address, the school will apply the address of the parent who claims the child's benefit as the pupil's address for determining this criterion. If neither parent claims child benefit other documentary evidence (eg medical card) may be required. If it is found that you have given a false address your child may lose their school place.

3 - Children who will have a sibling attending the school at the time of their admission.

Included in this factor are siblings who will be attending the school at the expected time of admission. Sibling means a child living as part of the same family unit at the same address. This includes natural siblings, adopted siblings, step siblings, foster siblings, and the child of a parent's partner. In the event of two applications for one vacancy the tie breaker decision will be based on geographical distance and given to the one living closest to the school.

Siblings for the same year group (twins/ multiple births)

Where there are twins or triplets to be admitted to a school in the same year group. If there are insufficient places available for all siblings, and one can be allocated a place, the admission number will be exceeded to allow them to be placed in the same school.

4 - Children who live closest to the school.

The distance will be determined by measuring the shortest available route using the public road and path network from the pupil's home to the main school gate, as determined by the school. The distance will be measured by using a computerised geographical information system (GIS). Priority will be given to those living nearest to the school using this system. Pupils living in flats where the distance measures the same, priority will be given in ascending order of flat number/letter/floor.

Tie Breakers

Where the offer of a place would lead to oversubscription under any of the above factors places will be allocated by reference to subsequent factors in order. In exceptional circumstances where it has not been possible to decide between applications, because they have the same distance measurements, the place will be allocated by drawing lots and will be independently verified.

Waiting Lists

1. If the school is over-subscribed a waiting list will be established.
2. Pupils will automatically be put on the waiting list where they have not been made an offer of a place and where the school is a higher preference than the school or academy at which an offer has been made.
3. Pupils will not automatically be placed on the waiting list if the school is ranked lower than the school or academy where they have been offered a place.

4. As further applications are submitted each added child will require the list to be ranked again in line with the published criteria.
5. The council will coordinate the waiting list for the school.
6. As soon as places become available they will be filled from the waiting list.
7. If a parent is on a waiting list it will not affect the parent's right of appeal against an unsuccessful application.
8. Looked after children, previously looked after children, and those allocated a place at a school in accordance with the Fair Access Protocol will take precedence over those on the waiting list.

Admission of children below compulsory school age

A child reaches compulsory school age on the prescribed day following his or her fifth birthday (or on his or her fifth birthday if it falls on a prescribed day). The prescribed days are 31 December, 31 March and 31 August.

St Peter and St Paul Church of England Primary School provides for the admission of all children in the September following their fourth birthday. Where a child has been offered a place that child is entitled to a full-time place in the September following their fourth birthday. The child's parents can defer the date their child is admitted to the school until later in the school year but not beyond the point at which they reach compulsory school age and not beyond the beginning of the final term of the school year for which it was made. Where the parents wish, children may attend part-time until later in the school year but not beyond the point at which they reach compulsory school age.

Admission outside of the Normal Age Group

Parents may seek a place for their child outside of the normal age group, for example, if the child is gifted and talented or has experienced problems such as ill health. In addition, the parents of a summer born child (1 April to 31 August) may choose not to send that child to school until the September following their fifth birthday and may request that they are admitted out of their normal age group – to reception rather than year one.

When requesting admission outside the normal age group, the parents should firstly complete the standard application for the normal age group. In addition, they should contact the council's Admissions Team to ask for an "admission outside the normal age group" form to be sent to them. That form should also be completed and submitted. On the "admission outside the normal age group" form they should list the schools they wish to consider their request, give information about why they are making the request, and submit any relevant evidence they may have (for example, if their child is receiving support from a speech and language therapist).

The council will consider their request on the circumstances of each case and in the best interest of the child concerned. This will include taking account of the parent's views; information about the child's academic, social and emotional development; where relevant, their medical history and the views of a medical professional; whether they have previously been educated out of their normal age group; and whether they may naturally have fallen into a lower age group if it were not for being born prematurely; and the views of the head teacher of the school concerned. After consideration, the council will make a recommendation to the school on the request but it will be for the school to make the final decision on whether the request will be agreed.

Withdrawing Offers of Places

Once an offer of a school place has been made it may only be withdrawn in very limited circumstances. These include when the admission authority offered a place on the basis of an intentionally misleading application from a parent (for example, a false claim of residence in a catchment area) which effectively denied a place to a child with a stronger claim. Where a place is withdrawn the application will be considered afresh, and a right of appeal offered if a place is refused.

Appeals

If your child is not allocated a place, parents/carers have a statutory right to appeal. All appeals will be heard by an independent appeals panel. The decision of the panel will be binding both on you and on the school.

Application during the school year

Parents wishing to make application for any other year group must complete an in year common application form available from your home local authority. North Lincolnshire parents can complete an "in year common application form" on the council's website or contact the admissions team via email: admissionstoschools@northlincs.gov.uk or telephone: 01724 297133/4

Objections to these arrangements

Any admission authority or person (parent, carer or guardian) wishing to object to any part of these determined arrangements must do so by the 15th May 2021.

Any person or body can make an objection to the schools adjudicator when they consider that these arrangements are unlawful or not in compliance with the school admissions code or relevant law relating to admissions.

Further information on how to make an objection can be obtained from the Office of the Schools Adjudicator www.schoolsadjudicator.gov.uk

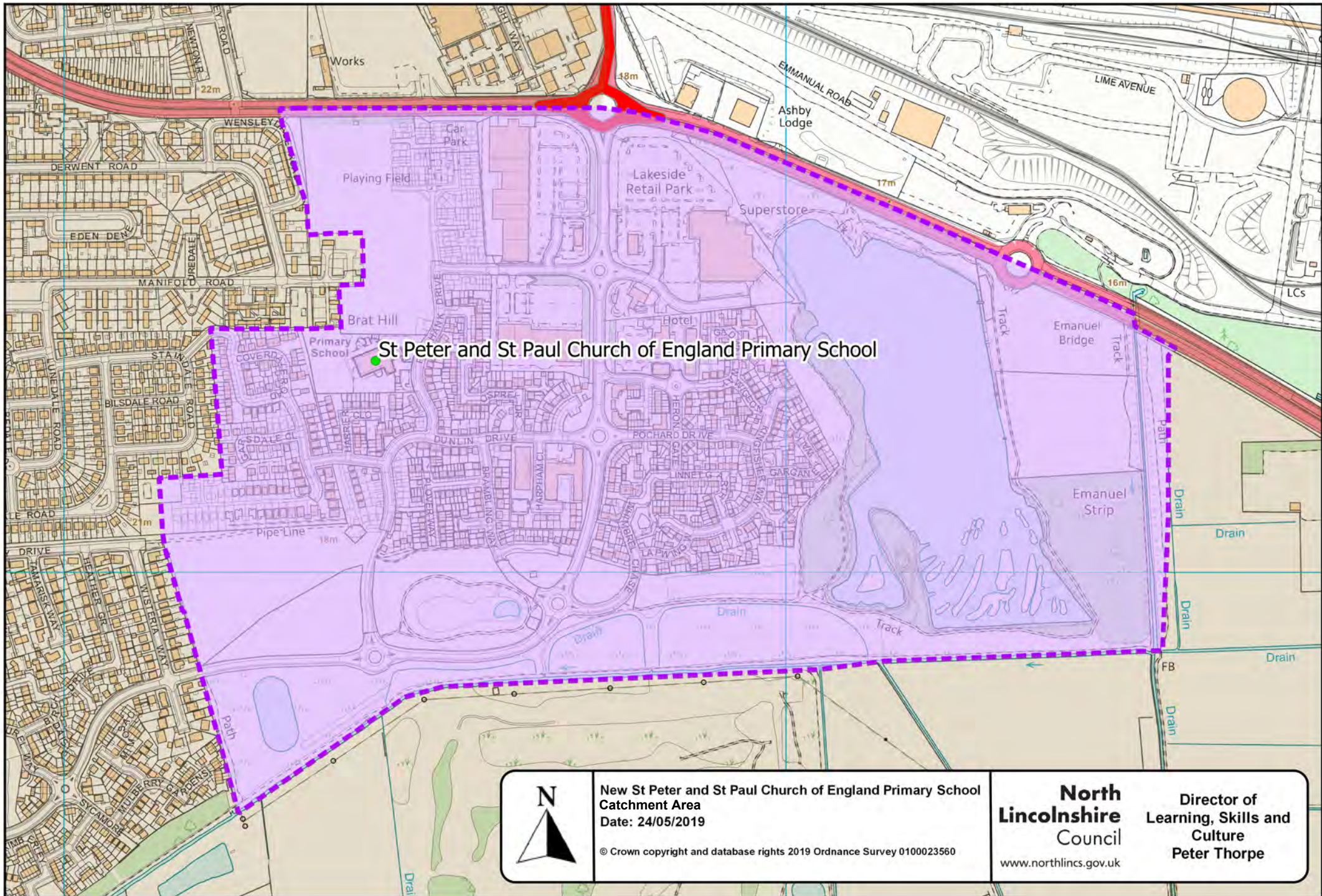

St Peter and St Paul Church of England Primary School



**New St Peter and St Paul Church of England Primary School
Catchment Area**
Date: 24/05/2019
© Crown copyright and database rights 2019 Ordnance Survey 0100023560

**North
Lincolnshire
Council**
www.northlincs.gov.uk

**Director of
Learning, Skills and
Culture
Peter Thorpe**