

WILDLIFE AND COUNTRYSIDE ACT 1981

**DEFINITIVE MAP MODIFICATION
(Public Footpath 127 West Butterwick) ORDER
2005(1)**



**County of Lincoln – Parts of Lindsey
(Isle of Axholme)
Definitive Map and Statement**

Wildlife and Countryside Act 1981

County of Lincoln - Parts of Lindsey (Isle of Axholme) Definitive Map and Statement

Definitive Map Modification (Public Footpath 127 West Butterwick) Order 2005(1)

This order is made by North Lincolnshire Council under section 53(2)(b) of the Wildlife and Countryside Act 1981 ("the Act") because it appears to that authority that the County of Lincoln - Parts of Lindsey (Glanford Brigg) Definitive Map and Statement require modification in consequence of the occurrence of an event specified in section 53(3)(a)(i) - namely, the coming into operation of any enactment or instrument, or any other event, whereby a new right of way has been created over land in the area to which the map relates, being a right of way such that the land over which the right subsists is a public path - of the Act.

The authority have consulted every local authority whose area includes the land to which the order relates. North Lincolnshire Council hereby order that:

1. For the purposes of this order the relevant date is 28th October 2005.
2. The County of Lincoln - Parts of Lindsey (Isle of Axholme) Definitive Map and Statement shall be modified as described in Part 1 and Part 2 of the Schedule and shown on the map attached to the order.
3. This order shall take effect on the date it is made and may be cited as the Definitive Map Modification (Public Footpath 127 West Butterwick) Order 2005(1).

SCHEDULE

PART 1

Modification of County of Lincoln Parts of Lindsey (Isle of Axholme) Definitive Map

Description of path to be deleted

A – B as indicated on the map: A 49-metre-long footpath commencing at a point on the existing footpath on the southern boundary of O.S.Field number 1695 at grid reference SE8325505932, proceeding in a north-easterly to the western end of footpath 125 at grid reference SE8329805954.

Description of path to be added

A – C as indicated on the map: A 43-metre-long footpath with a width of 1.2 metres commencing at a point on the existing footpath and the southern boundary of O.S. Field number 1695 at grid reference SE8325505932, proceeding along the north side of some fabricated buildings and the south side of an area of scrubland in a easterly direction to a point on the east side of a high grass bank and the west side of a security fence at grid reference SE8329805932.

C – B as indicated on the map: A 22-metre-long footpath with a width of 1.2 metres commencing on the east side of a high grass bank and the west side of a security fence at grid reference SE8329805932, proceeding along the east side of the same grass bank and the west side of the same security fence in a northerly direction to the western end of footpath 125 at grid reference SE8329805954.

PART 2

Modification of Parts of Lindsey (Isle of Axholme) Definitive Statement

Variation of particulars of path

A 65-metre-long footpath with a width of 1.2 metres commencing at a point on the existing footpath and the southern boundary of O.S. Field number 1695 at grid reference SE8325505932, proceeding along the north side of some fabricated buildings and the south side of an area of scrubland in a easterly direction to a point on the east side of a high grass bank and the west side of a security fence at grid reference SE8329805932, and then along the east side of the same grass bank and the west side of the same security fence in a northerly direction to the western end of footpath 125 at grid reference SE8329805954.

**THE COMMON SEAL of
NORTH LINCOLNSHIRE COUNCIL**

Was hereto affixed

In the presence of:

M Wood
(authorised signatory)

Seal No:

Dated: *9th November 2005*



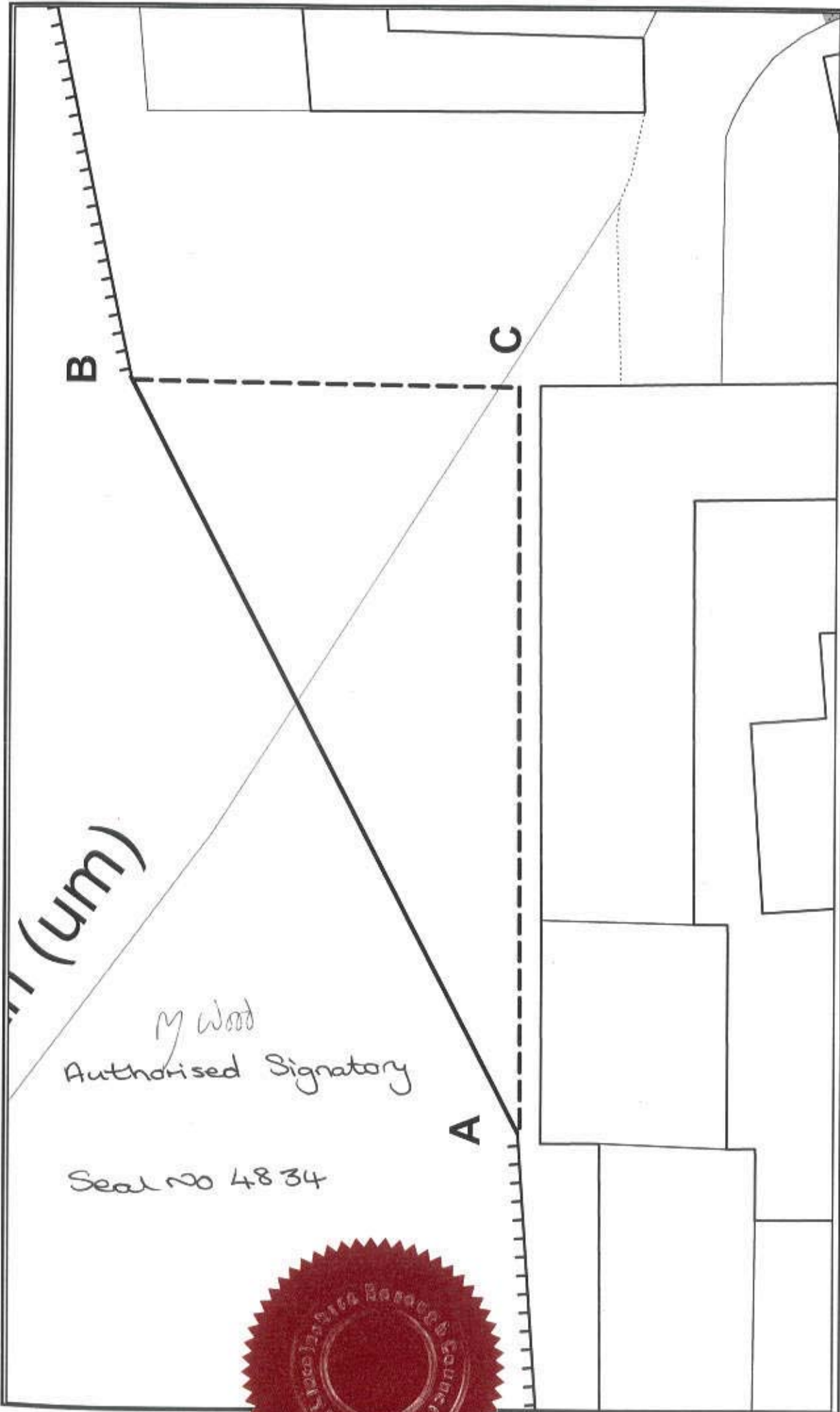

 <p>Planning and Regeneration Service Head of Service, T Lyman BSc(Hons), DipTP, MRTP</p>	<p>Drawing Title: West Butterwick FP127</p>	
	<p>Drawn by: AG</p>	<p>Date: 08.07.05</p>
	<p>Scale: 1:300</p>	
<p>Based upon the Ordnance Survey mapping with the permission of Ordnance Survey on behalf of the Controller of Her Majesty's Stationery Office © Crown Copyright. Unauthorised reproduction infringes Crown Copyright and may lead to prosecution or civil proceedings. NORTH LINCOLNSHIRE COUNCIL 100013349 2005</p>		
<p>The Ordnance Survey map data included within this publication is provided by North Lincolnshire Council under license from Ordnance Survey in order to fulfil its public function to act as a planning authority. Persons viewing this mapping should contact Ordnance Survey copyright for advice where they wish to license Ordnance Survey map data for their own use.</p>		