

**Wildlife and Countryside Act 1981
Section 53**

**County of Lincoln – Parts of Lindsey
(Glanford Brigg) Definitive Map and
Statement**

**Definitive Map Modification (Public
Bridleway 196, Scunthorpe) Order
2013(1)**



Wildlife and Countryside Act 1981

County of Lincoln, Parts of Lindsey (Glanford Brigg), Definitive Map and Statement

"Definitive Map Modification (Public Bridleway 196, Scunthorpe) Order 2013(1)"

This order is made by North Lincolnshire Council under section 53(2)(b) of the Wildlife and Countryside Act 1981 ("the Act") because it appears to that authority that the County of Lincoln, Parts of Lindsey (Glanford Brigg), Definitive Map and Statement require modification in consequence of the occurrence of an event specified in section 53(3)(a)(iii) – namely, a new right of way has been created over land in the area to which the map relates, being a right of way such that the land over which the right subsists is a public path or restricted byway – of the Act.

The authority have consulted every local authority whose area includes the land to which the order relates. North Lincolnshire Council hereby order that:

1. For the purposes of this order the relevant date is 16 December 2013.
2. The County of Lincoln, Parts of Lindsey (Glanford Brigg), Definitive Map and Statement shall be modified as described in Part I and Part II of the Schedule and shown on the map attached to the order.
3. This order shall take effect on the date it is made and may be cited as the "Definitive Map Modification (Public Bridleway 196, Scunthorpe) Order 2013(1)".

The COMMON SEAL of
NORTH LINCOLNSHIRE COUNCIL
was hereunto affixed
in the presence of:

(authorised signatory)

Dated: *W. Bley*
19th December 2013

Seal Number: 7374



SCHEDULE

PART I

Modification of Definitive Map

Description of path or way to be added

A – B, as indicated on the map: a 1,180-metre-long bridleway proceeding from its junction with Lakeside Parkway at grid reference SE91660790 opposite the pumping station close to the Whimbrel Chase roundabout southwards to Bottesford Beck thence generally west south westwards over a defined path adjacent to the northern side of Bottesford Beck to the Bottesford parish boundary at grid reference SE90650739.

PART II

Modification of Definitive Statement

Variation of particulars of path or way

A 1,180-metre-long bridleway of a width of three metres throughout proceeding from a terminus a quo at its junction with Lakeside Parkway at grid reference SE91660790 opposite the pumping station close to the Whimbrel Chase roundabout southwards to Bottesford Beck thence generally west south westwards over a defined path adjacent to the northern side of Bottesford Beck to a terminus ad quem at the Bottesford parish boundary at grid reference SE90650739.

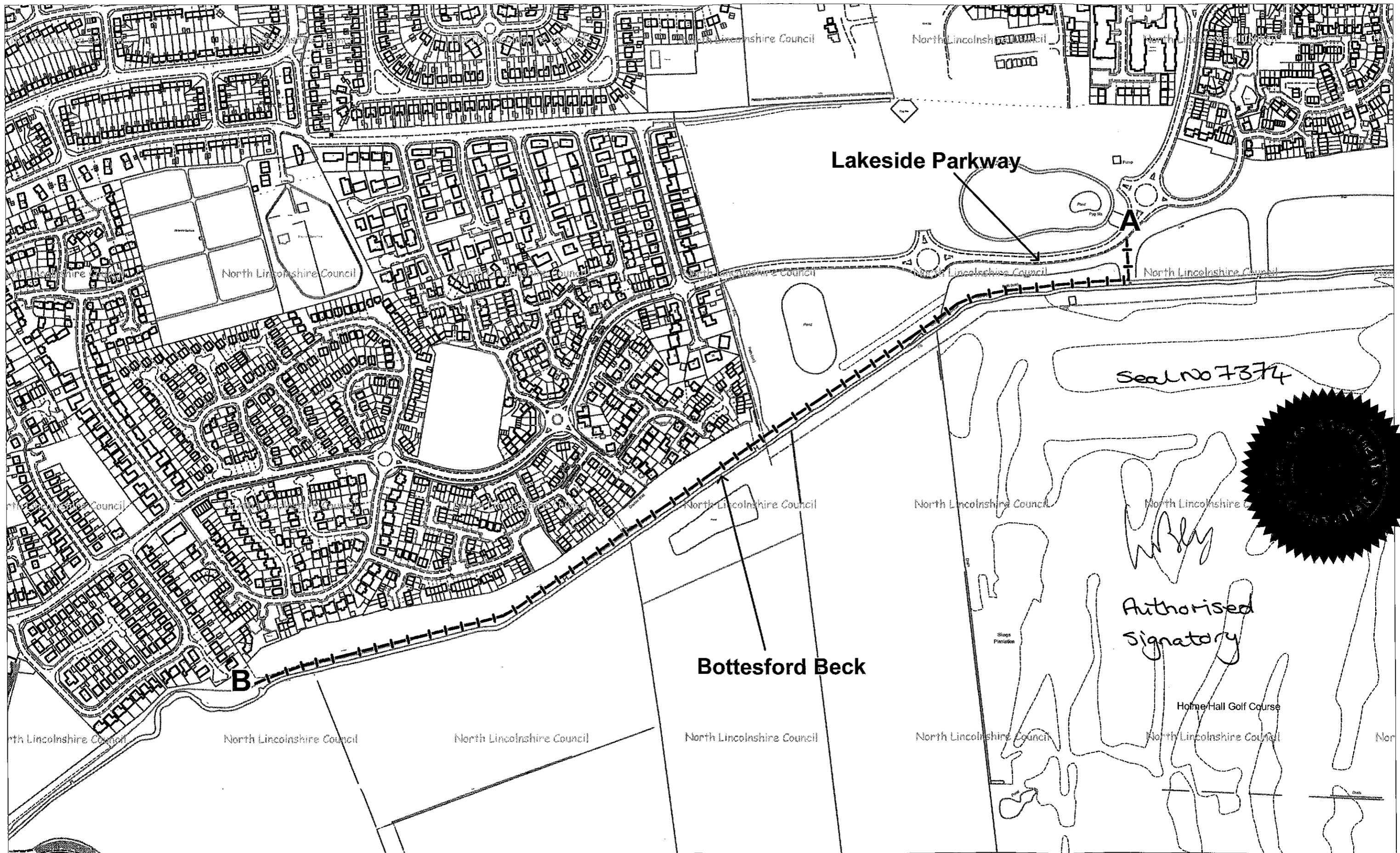

© Crown copyright and database rights 2012
Ordnance Survey 0100023560

Drawing Title: title_text

Drawn by: CTW

OS Grid Ref: SE91310760

Scale: 1:4000

Date: 18/12/2013



Places
Director,
Peter Williams BSc, DMS, CEng, MEI, MCM, AMIMechE