

WILDLIFE AND COUNTRYSIDE ACT 1981

**DEFINITIVE MAP MODIFICATION (Public Footpath 86,
New Holland) Order 2005(1)**



**County of Lincoln – Parts of Lindsey (Glanford Brigg)
Definitive Map and Statement**

Wildlife and Countryside Act 1981

County of Lincoln – Parts of Lindsey (Glanford Brigg) Definitive Map and Statement

Definitive Map Modification (Public Footpath 86, New Holland) Order 2005(1)

This order is made by North Lincolnshire Council under section 53(2)(b) of the Wildlife and Countryside Act 1981 ("the Act") because it appears to that authority that the County of Lincoln – Parts of Lindsey (Glanford Brigg) Definitive Map and Statement require modification in consequence of the occurrence of an event specified in section 53(3)(a)(i) – namely, the coming into operation of any enactment or instrument, or any other event, whereby a highway shown or required to be shown in the map or statement has been authorised to be stopped up, diverted, widened or extended – of the Act.

The authority have consulted every local authority whose area includes the land to which the order relates. North Lincolnshire Council hereby order that:

1. For the purposes of this order the relevant date is 3rd May 2005.
2. The County of Lincoln – Parts of Lindsey (Glanford Brigg) Definitive Map and Statement shall be modified as described in Part 1 and Part 2 of the Schedule and shown on the map attached to the order.
3. This order shall take effect on the date it is made and may be cited as the Definitive Map Modification (Public Footpath 86, New Holland) Order 2005(1).

SCHEDULE

PART 1

Modification of Parts of Lindsey (Glanford Brigg) Definitive Map

Description of path to be deleted

A – B as indicated on the map: A 267-metre-long footpath commencing midway along the northern boundary of O.S. Field number 0006 at grid reference TA1500419080, proceeding along the northern boundary of O.S. Field numbers 0006 and 1600 in a easterly direction to the north-eastern corner of O.S. Field number 1600 at grid reference TA1522819228.

B – C as indicated on the map: A 60-metre-long footpath commencing at the north-eastern corner of O.S. Field number 1600 at grid reference TA1522819228, proceeding along the western boundary of O.S. Field number 3121 in a northerly direction to the north-western corner of O.S. Field number 3121 at grid reference TA1520819279.

C – D as indicated on the map: A 524-metre-long footpath commencing at the north-western corner of O.S. Field number 3121 at grid reference TA1520819279, proceeding along the northern boundary of O.S. Field numbers 3121, 4427 and 5938 in a easterly direction to the north-eastern corner of O.S. Field number 5938 at grid reference TA1566819509.

Description of path to be added

A – E as indicated on the map: A 333-metre-long footpath with a width of 2 metres commencing midway along the existing footpath at the northern boundary of O.S. Field number 0129 at grid reference TA1500419080, proceeding first over a 4 metre footbridge and then along the western boundary of O.S. Field number 0129 and the western side of an enclosure fence in a northerly direction before crossing a further 4 metre footbridge to the junction with footpath No.79 at the northern end of the field at grid reference TA1479619431.

E – F as indicated on the map: A 66-metre-long footpath with a width of 2 metres commencing midway along the southern boundary of O.S. Field number 8745 at grid reference TA1487419385, proceeding along the southern boundary of the

same field and the north side of a drainage dyke in a south-westerly direction to the junction with footpath 79 at grid reference TA1483519332.

PART 2

Modification of Parts of Lindsey (Glanford Brigg) Definitive Statement

Variation of particulars of path

A 399-metre-long footpath with a width of 2 metres commencing midway along the existing footpath at the northern boundary of O.S. Field number 0129 at grid reference TA1500419080, proceeding first over a 4 metre footbridge and then along the western boundary of O.S. Field number 0129 and the western side of an enclosure fence in a northerly direction before crossing a further 4 metre footbridge to the junction with footpath No.79 at the northern end of the field at grid reference TA1479619431, and then along the southern boundary of the same field and the north side of a drainage dyke in a south-westerly direction to the junction with footpath 79 at grid reference TA1483519332.

THE COMMON SEAL of
NORTH LINCOLNSHIRE COUNCIL
Was hereto affixed
In the presence of:

M Wood
(Authorised signatory)

Seal No.: *4650*

Dated: *26th May 2005*



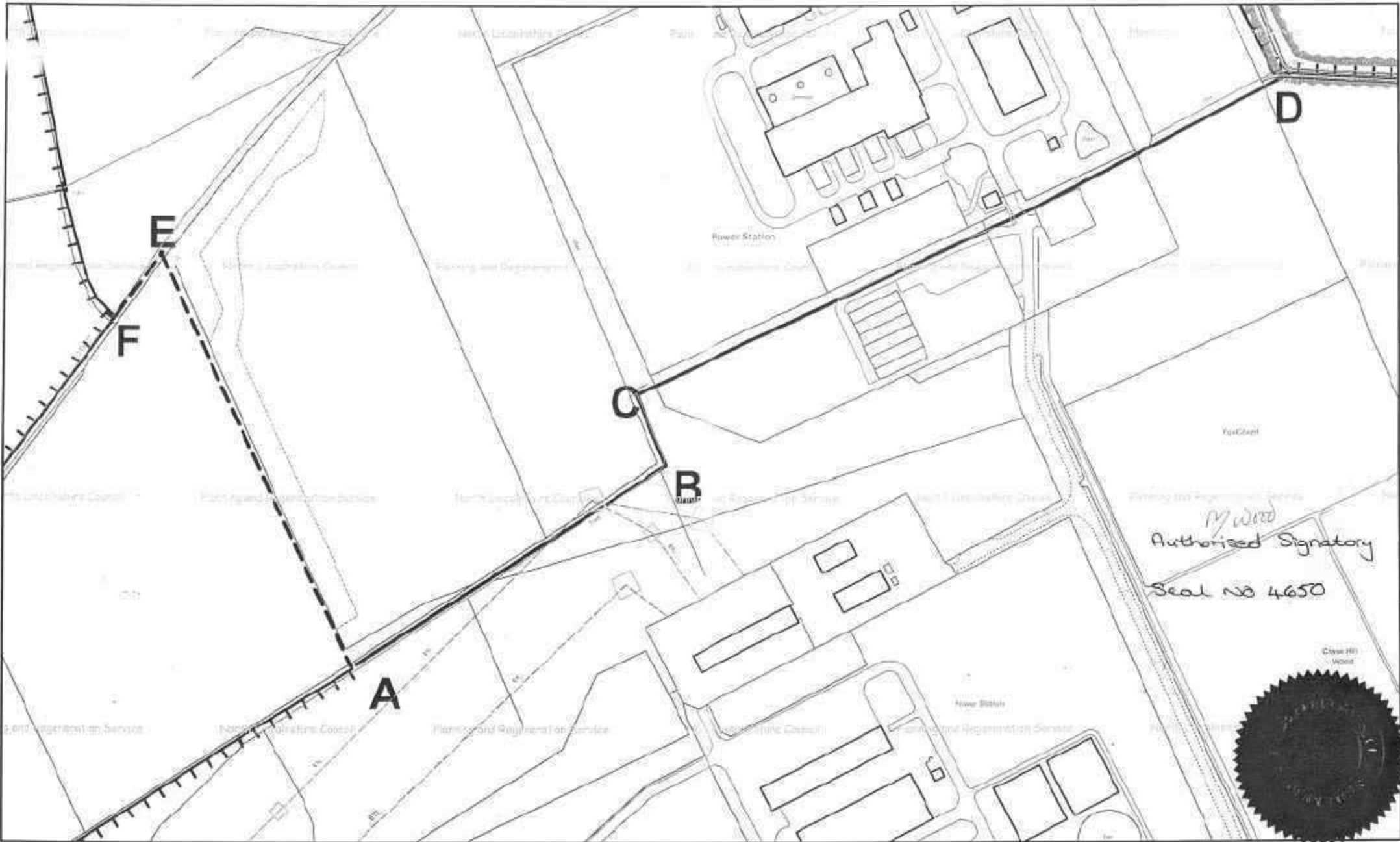

Based upon the Ordnance Survey mapping with the permission of
Ordnance Survey on behalf of the Controller of Her Majesty's Stationery Office.
© Crown Copyright.
Unauthorized reproduction infringes Crown Copyright
and may lead to prosecution or civil proceedings.
NORTH LINCOLNSHIRE COUNCIL 100013349 2005

Drawing Title: New Holland 86

Drawn by: TT

Scale: 1:2,500

OS Grid Ref. TA1125719256

Date: 09/05/2005



Planning and Regeneration Service
Head of Service
T Lyman (acting) S4/TP/ARTR

The Ordnance Survey map data included with this publication is provided by North Lincolnshire Council under license from Ordnance Survey in order to fulfil its public functions and as planning authority. Persons viewing this map should contact Ordnance Survey copyright for advice where they wish to source Ordnance Survey map data for their own use.