

WILDLIFE AND COUNTRYSIDE ACT 1981

**DEFINITIVE MAP MODIFICATION (Public Footpath 77,
New Holland) ORDER 2005(1)**



**County of Lincoln – Parts of Lindsey (Glanford Brigg)
Definitive Map and Statement**

Wildlife and Countryside Act 1981

County of Lincoln – Parts of Lindsey (Glanford Brigg) Definitive Map and Statement

Definitive Map Modification (Public Footpath 77, New Holland) Order 2005(1)

This order is made by North Lincolnshire Council under section 53(2)(b) of the Wildlife and Countryside Act 1981 ("the Act") because it appears to that authority that the County of Lincoln – Parts of Lindsey (Glanford Brigg) Definitive Map and Statement require modification in consequence of the occurrence of an event specified in section 53(3)(a)(i) – namely, the coming into operation of any enactment or instrument, or any other event, whereby a highway shown or required to be shown in the map or statement has been authorised to be stopped up, diverted, widened or extended – of the Act.

The authority have consulted every local authority whose area includes the land to which the order relates. North Lincolnshire Council hereby order that:

1. For the purposes of this order the relevant date is 3rd May 2005.
2. The County of Lincoln – Parts of Lindsey (Glanford Brigg) Definitive Map and Statement shall be modified as described in Part 1 and Part 2 of the Schedule and shown on the map attached to the order.
3. This order shall take effect on the date it is made and may be cited as the Definitive Map Modification (Public Footpath 77, New Holland) Order 2005(1).

SCHEDULE

PART 1

Modification of Parts of Lindsey (Glanford Brigg) Definitive Map

Description of path to be deleted

A – B as indicated on the map: A 623-metre-long footpath commencing at the north-west corner of O.S. Field number 2266 at grid reference TA1500119523 proceeding in a easterly direction to the south-eastern corner of O.S. Field number 4300 at grid reference TA1556219707.

Description of path to be added

B – C as indicated on the map: A 469-metre-long footpath with a width of 2 metres commencing mid way along the existing footpath and the junction with footpath No.78 at the north-west corner of O.S. Field number 2266 at grid reference TA1507919610, proceeding along the northern boundary of O.S. Field numbers 2266 and 4300 and the southern side of a hedgerow in a north-easterly direction to the north-eastern corner of O.S. Field number 4300 at grid reference TA1536619977.

C – D as indicated on the map: A 346-metre-long footpath with a width of 2 metres commencing at the north-eastern corner of O.S. Field number 4300 at grid reference TA1536619977, proceeding along the eastern boundary of the same field and the western side of a security fence in a southerly direction to the existing footpath at the south-eastern corner of the same field at grid reference TA1556219707.

PART 2

Modification of Parts of Lindsey (Glanford Brigg) Definitive Statement

Variation of particulars of path

A 815-metre-long footpath with a width of two metres commencing midway along the existing footpath and the junction with footpath No.78 at the north-west corner of O.S. Field number 2266 at grid reference TA1507919610, proceeding along the northern boundary of O.S. Field numbers 2266 and 4300 and the southern side of a hedgerow in a north-easterly direction to the north-eastern corner of O.S. Field number 4300 at grid reference TA1536619977, and then along the eastern boundary of the same field and the western side of a security fence in a southerly direction to the existing footpath at the south-eastern corner of the same field at grid reference TA1556219707.

THE COMMON SEAL of
NORTH LINCOLNSHIRE COUNCIL

Was hereto affixed
In the presence of:

M Wood
(Authorised signatory)

Seal No.: *4649*

Dated: *26th May 2005*



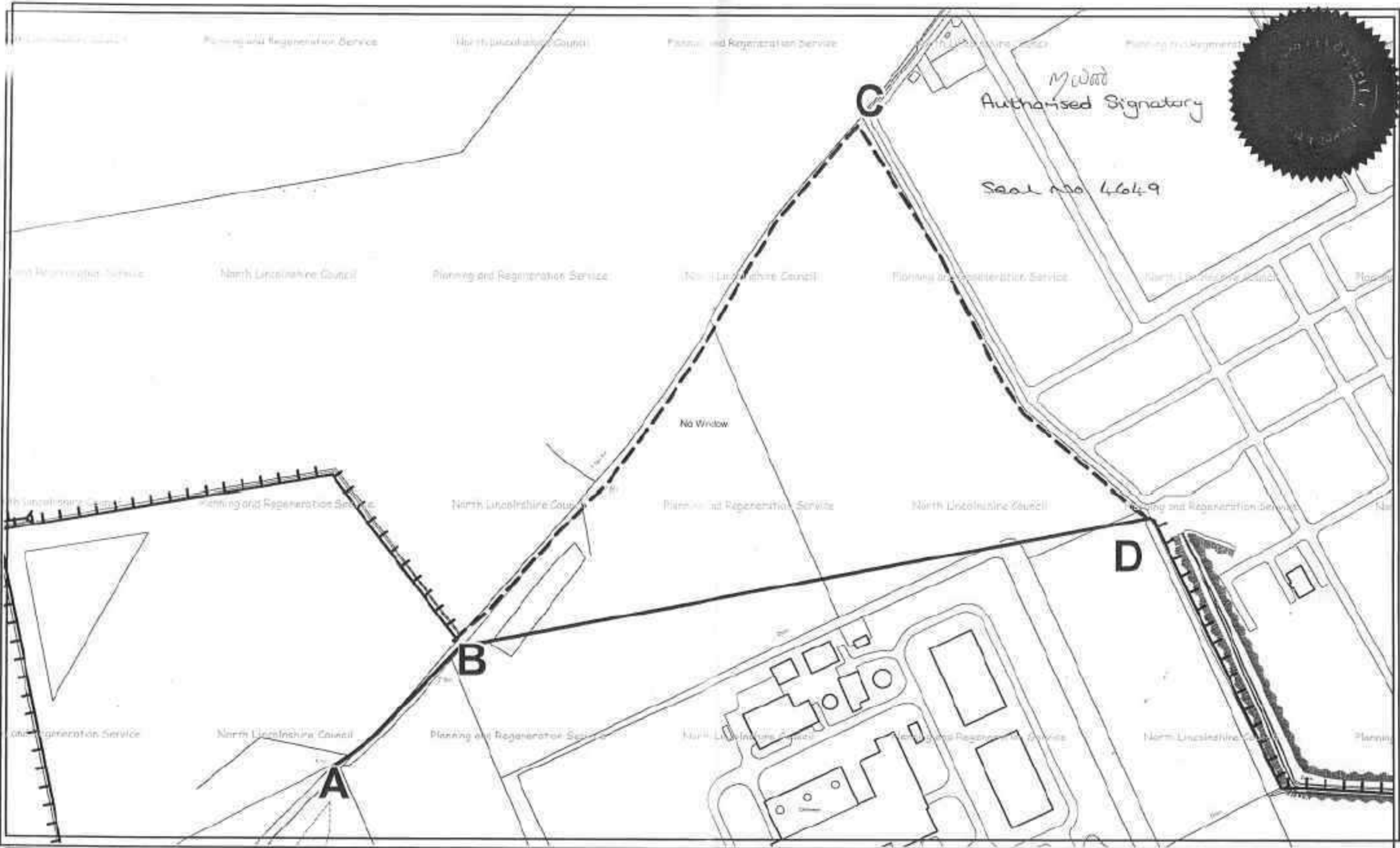

M. Watt
 Authorised Signatory

Seal no 4649



No Window



Based upon the Ordnance Survey map with the permission of
 Ordnance Survey on behalf of the Controller of Her Majesty's Stationery Office.
 © Crown Copyright.
 Unauthorised reproduction infringes Crown Copyright
 and may lead to prosecution or civil proceedings.
 NORTH LINCOLNSHIRE COUNCIL 100013349 2005

Drawing Title: New Holland 77

Drawn by: TT

OS Grid Ref: grid_text

Scale: 1:2,500

Date: 09/05/2005



Planning and Regeneration Service
 Head of Service
 T Lyman 01509 6611 6611

The Ordnance Survey map data included within this publication is provided by North Lincolnshire Council under license from Ordnance Survey in order to fulfil its public function to act as a planning authority. Persons viewing this map should contact Ordnance Survey (copyright for advice where they wish to license Ordnance Survey map data for their own use.