

WILDLIFE AND COUNTRYSIDE ACT 1981

**DEFINITIVE MAP MODIFICATION
(Public Footpath 198 Bottesford) ORDER 2005(2)**



**County of Lincoln – Parts of Lindsey
(Glanford Brigg)
Definitive Map and Statement**

Wildlife and Countryside Act 1981

County of Lincoln - Parts of Lindsey (Glanford Brigg) Definitive Map and Statement

**Definitive Map Modification (Public Footpath 198)
Order 2005(2)**

This order is made by North Lincolnshire Council under section 53(2)(a) of the Wildlife and Countryside Act 1981 ("the Act") because it appears to that authority that the County of Lincoln - Parts of Lindsey (Glanford Brigg) Definitive Map and Statement require modification in consequence of the occurrence of an event specified in section 53(3)(a)(i) - namely, the coming into operation of any enactment or instrument, or any other event, whereby a highway shown or required to be shown in the map or statement has been authorised to be stopped up, diverted, widened or extended - of the Act.

The authority have consulted every local authority whose area includes the land to which the order relates. North Lincolnshire Council hereby order that:

1. For the purposes of this order the relevant date is 25th November 2005.
2. The County of Lincoln - Parts of Lindsey (Glanford Brigg) Definitive Map and Statement shall be modified as described in the Schedule and shown on the map attached to the order.
3. This order shall take effect on the date it is made and may be cited as the "Definitive Map Modification (Public Footpath 198 Bottesford) Order 2005(2)".

SCHEDULE

Modification of Parts of Lindsey (Glanford Brigg) Definitive Map

Description of path to be deleted

A – B as indicated on the map: A 41-metre-long footpath commencing on Rowan Crescent at grid reference SE9005407478, proceeding in a northerly direction to its junction at Timberlands at grid reference SE9006207518.

**THE COMMON SEAL of
NORTH LINCOLNSHIRE COUNCIL**

Was hereunto affixed
In the presence of:

M Wood
(Authorised signatory)



Seal Number: *5924*

Dated: *13th February 2009*

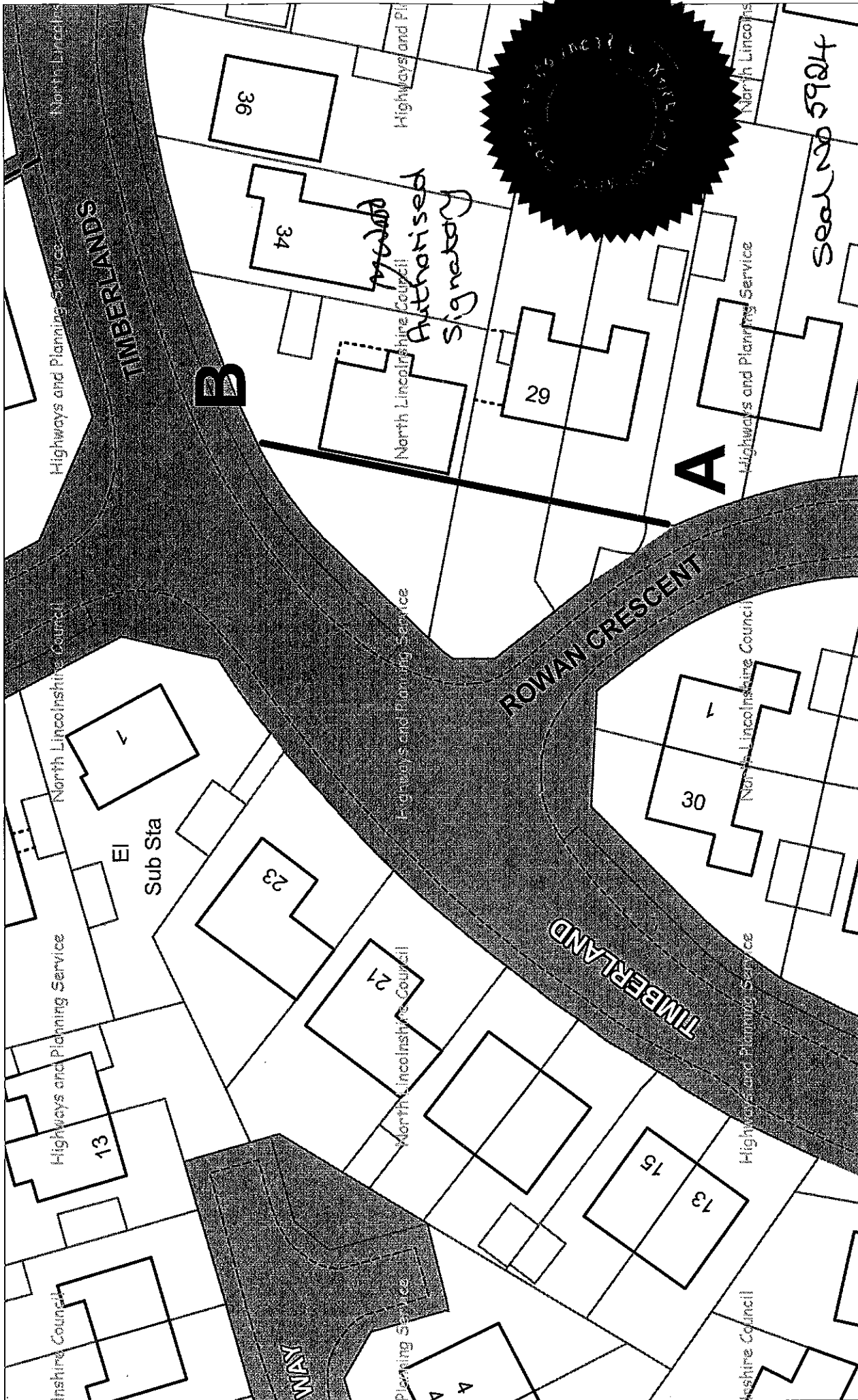

Highways and Planning Service
Service Director,
G Popple



NORTH LINCOLNSHIRE COUNCIL

Drawing Title: FOOTPATH 198 BOTTESFORD	
Drawn by: AG	Date: 23/12/2008
Scale: 1:500	OS Grid Ref: SE90030750

Based upon the Ordnance Survey mapping with the permission of Ordnance Survey on behalf of the Controller of Her Majesty's Stationary Office.
© Crown Copyright.
Unauthorised reproduction infringes Crown Copyright and may lead to prosecution or civil proceedings.

NORTH LINCOLNSHIRE COUNCIL 100013349 2008

The Ordnance Survey map data included within this publication is provided by North Lincolnshire Council under license from Ordnance Survey in order to fulfil its public function to act as a highways and planning authority. Persons viewing this mapping should contact Ordnance Survey copyright for advice where they wish to license Ordnance Survey map data for their own use.